

Conference Agenda

44th Annual NSMA Conference at the Country Inn & Suites
5353 N. 27th St., Lincoln, NE 68521, 402-476-5353
(Sessions and times subject to change)

Friday, April 16, 2010

8:00am - 9:00am	Pre-Conference Board Meeting (Nebraska Room)
10:30am - 12:30pm	Registration (Foyer of the Convention Center)
9:00am - 11:00am	House of Delegates
11:30am - 12:30pm	Lunch on your own
12:30pm - 1:00pm	Welcome to Lincoln by Mayor Chris Beutler (All sessions will be in the Nebraska Room)
1:00pm - 3:00pm	Health Information Exchange and Electronic /Virtual Medical Record Deb Bass, Bass & Associates
3:00pm - 3:30pm	Break
3:30pm - 4:30pm	Genetics Counseling for Hereditary Cancer Bronson Riley C.G.C, Southeast Nebraska Cancer Center
4:30pm - 5:30pm	The Aged & Disabled Waiver-Qualifying client criteria & services available Kay Wenzl, Nebraska DHHS
5:30pm - 6:30pm	Dinner
6:30pm - 7:30pm	Assistive Technology Partnership Jana Maresh, ATP
7:30pm - 8:30pm	TBD!

Saturday, April 17, 2010

7:30am - 9:00am	Registration (Foyer of the Convention Center)
9:00am - 10:00am	PTSD (Post Traumatic Stress Disorder) Todd Fleischer MD, Lincoln VA Hospital
10:00am – 10:30am	Break/Exhibits (Capital Room)
10:30am – 11:30am	Cancer Research TBD Stephen Dunder MD, Southeast Nebraska Cancer Center
11:30am – 12:30pm	National Representative from the AAMA Dr. Karen Minchella CMA (AAMA)
12:30pm – 2:00pm	Luncheon/Installation of NSMA Officers and Awards Ceremony
2:00pm – 4:00pm	Therapeutic Psychosocial Environment: Improving Quality of Life in Dementia Care Geri Hepp, Madonna Rehabilitation Hospital
4:00pm – 4:30pm	Break/Exhibits (Capital Room)
4:30pm – 5:30pm	Identity Theft in the Medical Office Pamela Moore, The Physician Network, St. Elizabeth Regional Medical Center
5:30pm – 6:30pm	Post Conference Board meeting (Capital Room)

Because we are honoring our elected officers and special guests this weekend, we ask that you dress in casual business attire, no jeans, scrubs, sweats or shorts, 'Thank you' for your professionalism and consideration."

Registration Form

44th ANNUAL NSMA CONFERENCE
April 16 & 17, 2010
Lincoln, Nebraska 68521

(PLEASE PRINT)

Name _____ Credentials _____ AAMA ID or Social Security # _____

Address _____ City _____ State _____ Zip _____

Employer _____ Telephone Work _____ Home _____

Fax Number _____ E-mail address _____

Chapter _____ Member _____ Nonmember _____ Student _____

Is this your first NSMA Conference? Y ___ N ___ Newly Certified Y ___ N ___ or Recertified since April 2009 Y ___ N ___.

Are you a Past State President Yes _____ No _____

FULL TWO DAY REGISTRATION

Members (meals & sessions)	\$110.00	\$ _____
Non-Members (meals & sessions)	\$200.00	\$ _____
Students (meals & sessions)	\$100.00	\$ _____
Students (sessions only)	\$ 25.00	\$ _____

FRIDAY ONLY

Members (meals & sessions)	\$ 60.00	\$ _____
Non-Members (meals & sessions)	\$110.00	\$ _____
Students (meals & sessions)	\$ 60.00	\$ _____
Students (sessions only)	\$ 10.00	\$ _____

SATURDAY ONLY

Members (meals & sessions)	\$ 80.00	\$ _____
Non-Members (meals & sessions)	\$120.00	\$ _____
Students (meals & sessions)	\$ 60.00	\$ _____
Students (sessions only)	\$ 15.00	\$ _____

Guest Dinner ticket for Friday evening dinner	_____ @ \$ 20.00	\$ _____
Guest Dinner ticket for the Saturday Luncheon/ Installation/ Awards Ceremony	_____ @ \$ 20.00	\$ _____

LATE FEE - \$10.00 (for registration sent after 04-02-10) \$ 10.00 \$ _____

TOTAL ENCLOSED \$ _____

To provide accurate accounts for setup and meal preparation, please mark the following:

I will attend the Friday evening meal. Yes _____ No _____ Guest ticket Yes _____ # _____ No _____

I will attend the Saturday luncheon/Awards Yes _____ No _____ Guest ticket Yes _____ # _____ No _____

Registration Deadline is April 2, 2010 – No Refunds after April 10, 2010
 Make check or money order out to: NSMA 2010 Conference fund.
 Mail completed form to: Lori Lesiak, CMA (AAMA)
 5000 W Champion Ct, Lincoln, NE 68524

Questions for Conference Chair Conference Chair is Lori Weskamp, CMA (AAMA)
 402-781-2428, moolaw@windstream.net
 Co-chair is Denise Arnold, CMA (AAMA), 402-420-5228, darnold@neuroandspinalsurg.com

Hotel Registration Information

NSMA Group Room rate deadline is Thursday March 25, 2010
FREE Continental Breakfast Included



5353 N. 27th St. Lincoln, NE 68521
(402) 476-5353
www.countryinns.com/lincolnne

1 room 2 double beds - \$105.00

1 room King bed - \$105.00

*If registered by Thursday, March 25, 2010

Check In-3:00pm

Check Out-Noon

Directions: Interstate 80 to exit #403, then go South on 27th St., 1.5 miles to hotel.
Country Inn & Suites is located on the West side of 27th St.

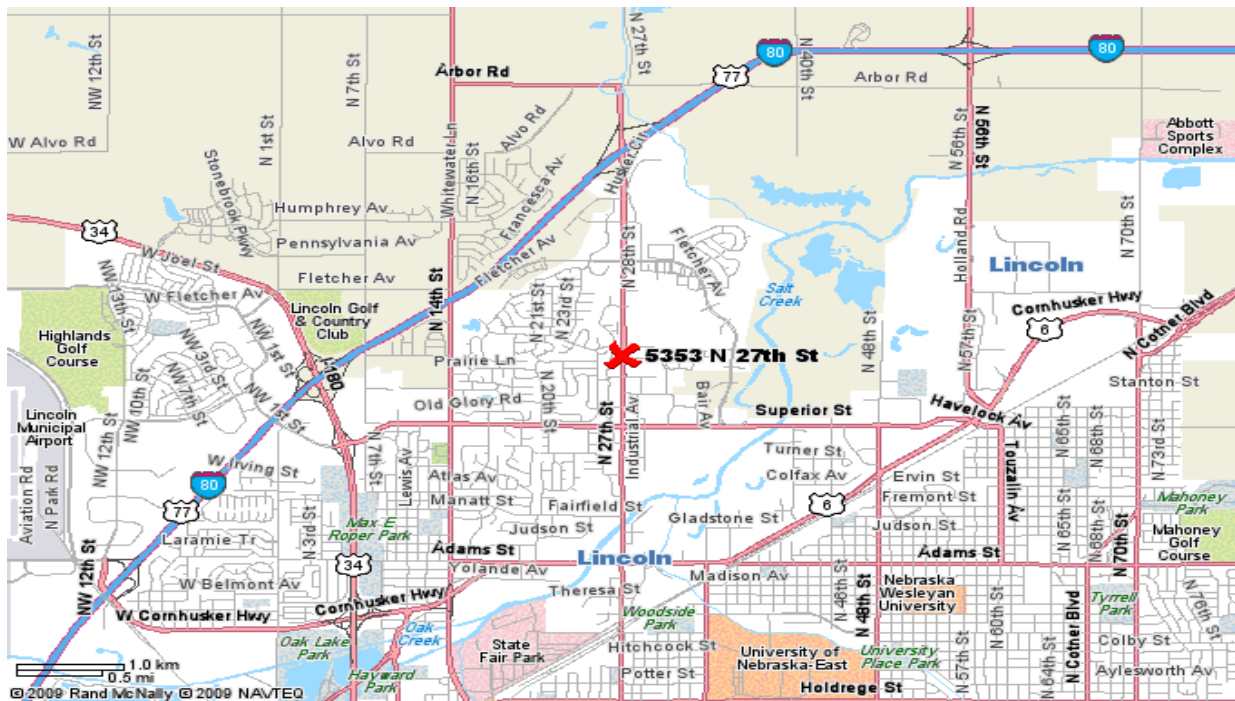

<http://www.randmcnally.com/rmc/directions/dirGetMap.jsp?cmty=0>